



SAW Components

Data Sheet X 9651 L





SAW Components

X 9651 L

Bandpass Filter

44,00 MHz

Data Sheet

Standard

Duroplast package **DIP18D**

- DVB-DAVIC

Features

- Bandpass filter for digital cable TV with two channels
- Channel 1: 3dB bandwidth 1,2 MHz
- Channel 2: 3dB bandwidth 1,8 MHz
- Constant group delay
- **Surface Mounted Technology (SMT)**
- Standard IC small outline (SO) package

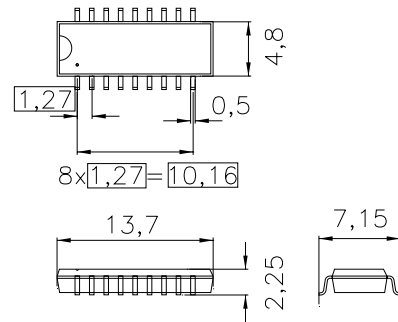

Terminals

- Tinned CuFe alloy

Dimensions in mm, approx. weight 0,5 g

Pin configuration

- 2 Input
- 3 Switching Input
- 7 Output
- 8 Output
- 1,4,5,6,9,10, 13,14,15,18 Chip carrier - ground
- 11,12,16,17 Not connected

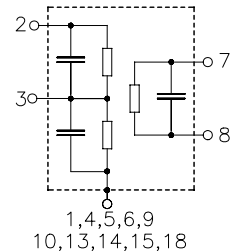

Type	Ordering code	Marking and package according to	Packing according to
X 9651 L	B39440-X9651-L100	C61157-A2-A4	F61074-V8058-Z000

Maximum ratings

Operable temperature range	T_A	-25/+65	°C	
Storage temperature range	T_{stg}	-40/+85	°C	
DC voltage	V_{DC}	5	V	between any terminals
AC voltage	V_{pp}	10	V	between any terminals

SAW Components
X 9651 L
Bandpass Filter
44,00 MHz
Data Sheet
Characteristics of channel 1 (switching pin 3 connected to ground)

Reference temperature: $T_A = 25 (45) ^\circ\text{C}$
 Terminating source impedance: $Z_S = 50 \Omega$
 Terminating load impedance: $Z_L = 2 \text{ k}\Omega \parallel 3 \text{ pF}$

		min.	typ.	max.	
Center frequency (center between 3 dB points)	f_C	—	44,00	—	MHz
Insertion attenuation Reference level for the following data	α 44,06(44,00) MHz	14,0	15,5	17,0	dB
Pass bandwidth					
$\alpha_{\text{rel}} \leq 1 \text{ dB}$	$B_{1\text{dB}}$	—	0,8	—	MHz
$\alpha_{\text{rel}} \leq 3 \text{ dB}$	$B_{3\text{dB}}$	—	1,2	—	MHz
$\alpha_{\text{rel}} \leq 30 \text{ dB}$	$B_{30\text{dB}}$	—	2,4	—	MHz
Relative attenuation	α_{rel}				
Lower sidelobe 35,06 ... 42,66 (35,00 ... 42,60) MHz		34,0	39,0	—	dB
Upper sidelobe 45,36 ... 47,36 (45,30 ... 47,30) MHz		25,0	29,0	—	dB
47,36 ... 55,06 (47,30 ... 55,00) MHz		34,0	39,0	—	dB
Group delay ripple (p-p)	$\Delta\tau$				
43,46 ... 44,66 (43,40 ... 44,60) MHz		—	50	—	ns
Impedance at 44,06 MHz					
Input: $Z_{\text{IN}} = R_{\text{IN}} \parallel C_{\text{IN}}$		—	0,5 \parallel 13,7	—	k Ω \parallel pF
Output: $Z_{\text{OUT}} = R_{\text{OUT}} \parallel C_{\text{OUT}}$		—	0,6 \parallel 6,8	—	k Ω \parallel pF
Temperature coefficient of frequency	TC_f	—	-72	—	ppm/K



SAW Components	X 9651 L
Bandpass Filter	44,00 MHz

Data Sheet

Characteristics of channel 2 (switching pin 3 connected to input pin 2)

Reference temperature: $T_A = 25 (45) \text{ }^\circ\text{C}$
 Terminating source impedance: $Z_S = 50 \text{ } \Omega$
 Terminating load impedance: $Z_L = 2 \text{ k}\Omega \parallel 3 \text{ pF}$

		min.	typ.	max.	
Center frequency (center between 3 dB points)	f_C	—	44,00	—	MHz
Insertion attenuation Reference level for the following data	α 44,06(44,00) MHz	12,8	14,3	15,8	dB
Pass bandwidth					
$\alpha_{\text{rel}} \leq 1 \text{ dB}$	$B_{1\text{dB}}$	—	1,6	—	MHz
$\alpha_{\text{rel}} \leq 3 \text{ dB}$	$B_{3\text{dB}}$	—	1,8	—	MHz
$\alpha_{\text{rel}} \leq 30 \text{ dB}$	$B_{30\text{dB}}$	—	2,7	—	MHz
Relative attenuation	α_{rel}				
Lower sidelobe					
35,06 ... 40,26 (35,00 ... 40,20) MHz		38,0	44,0	—	dB
40,26 ... 42,56 (40,20 ... 42,50) MHz		32,0	36,0	—	dB
Upper sidelobe					
45,56 ... 48,66 (45,50 ... 48,60) MHz		24,0	30,0	—	dB
48,66 ... 55,06 (48,60 ... 55,00) MHz		36,0	42,0	—	dB
Group delay ripple (p-p)	$\Delta\tau$				
43,16 ... 44,96 (43,10 ... 44,90) MHz		—	50	—	ns
Impedance at 44,06 MHz					
Input: $Z_{\text{IN}} = R_{\text{IN}} \parallel C_{\text{IN}}$		—	0,7 \parallel 19,0	—	k Ω \parallel pF
Output: $Z_{\text{OUT}} = R_{\text{OUT}} \parallel C_{\text{OUT}}$		—	0,6 \parallel 6,9	—	k Ω \parallel pF
Temperature coefficient of frequency	TC_f	—	-72	—	ppm/K



SAW Components

X 9651 L

Bandpass Filter

44,00 MHz

Data Sheet

Frequency response of channel 1

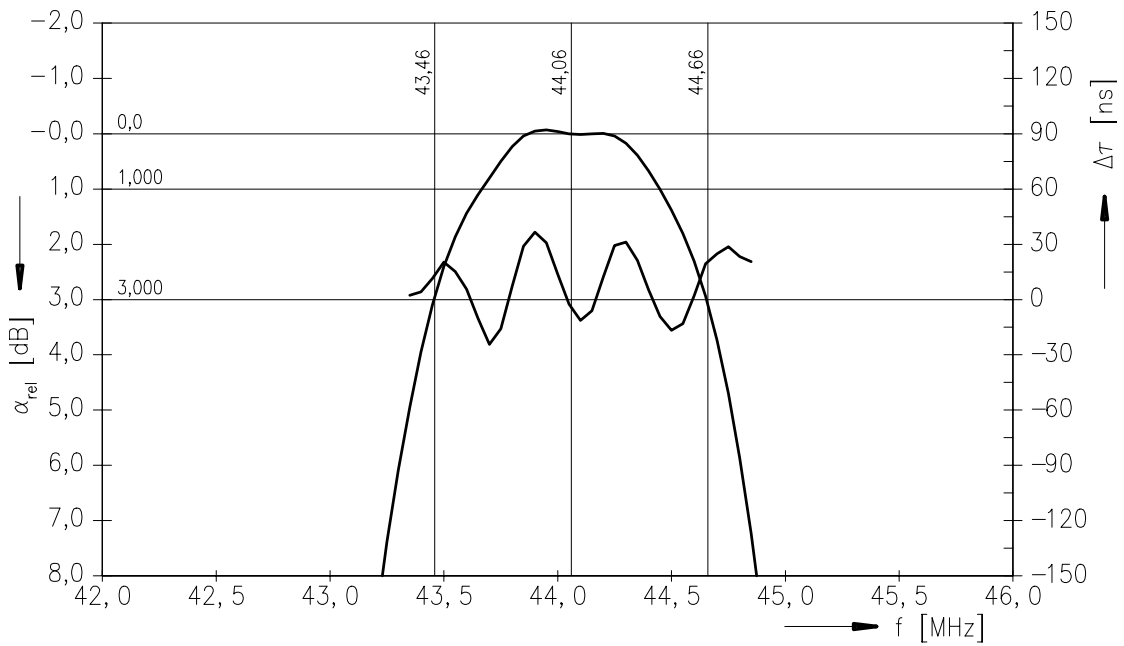
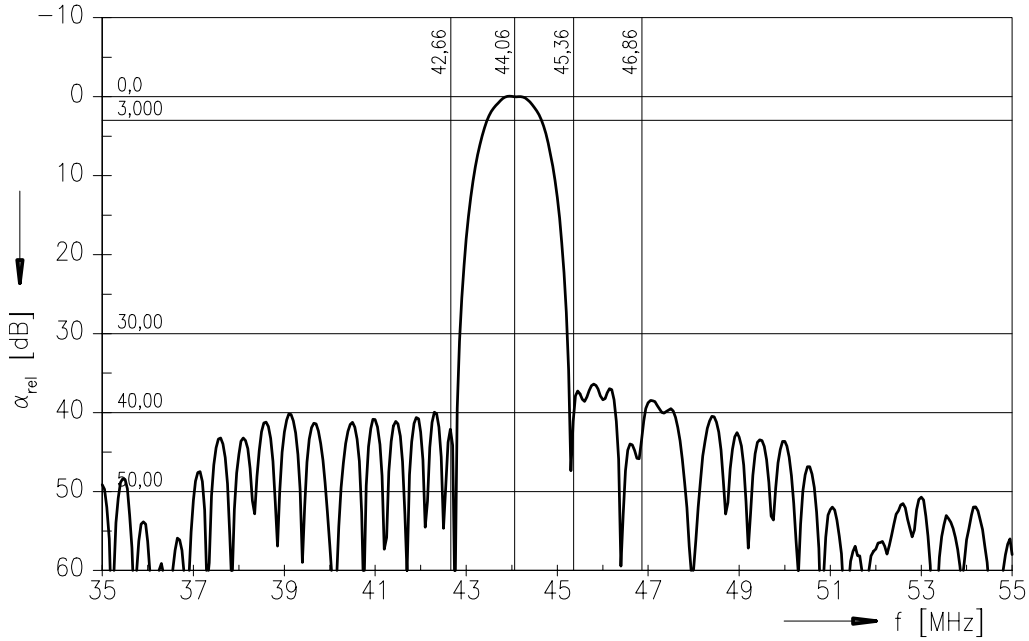



SAW Components

X 9651 L

Bandpass Filter

44,00 MHz

Data Sheet

Frequency response of channel 2

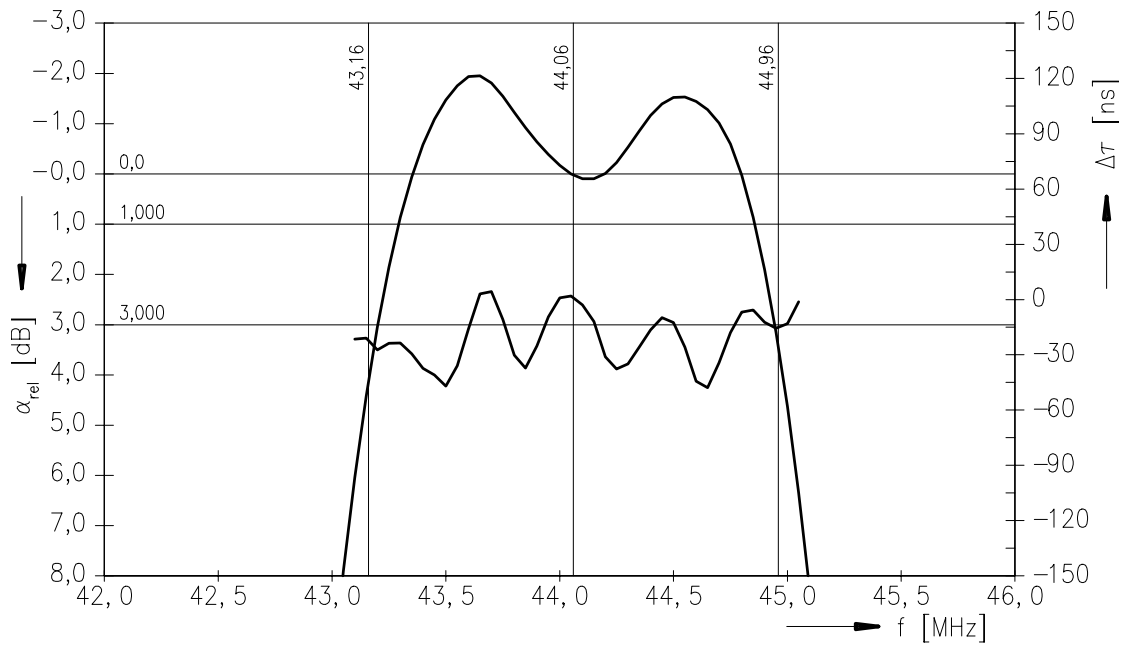
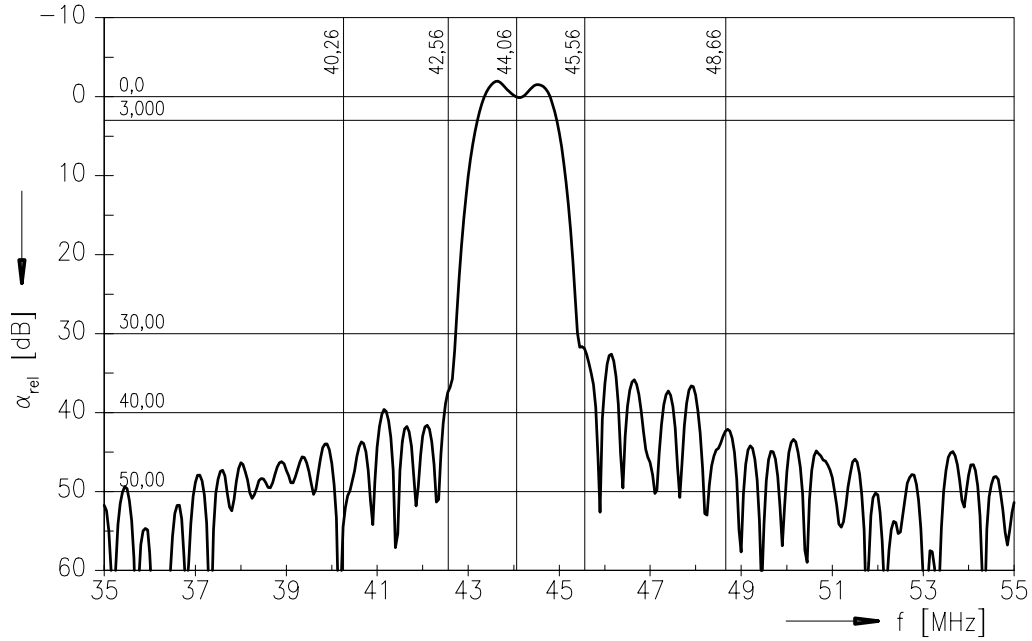



SAW Components

X 9651 L

Bandpass Filter

44,00 MHz

Data Sheet

Published by EPCOS AG

Surface Acoustic Wave Components Division, SAW CE MM PD

P.O. Box 80 17 09, 81617 Munich, GERMANY

© EPCOS AG 2003. Reproduction, publication and dissemination of this brochure and the information contained therein without EPCOS' prior express consent is prohibited.

Purchase orders are subject to the General Conditions for the Supply of Products and Services of the Electrical and Electronics Industry recommended by the ZVEI (German Electrical and Electronic Manufacturers' Association), unless otherwise agreed.

This brochure replaces the previous edition.

For questions on technology, prices and delivery please contact the Sales Offices of EPCOS AG or the international Representatives.

Due to technical requirements components may contain dangerous substances. For information on the type in question please also contact one of our Sales Offices.